

OFFICE / SHOWROOM / WAREHOUSE

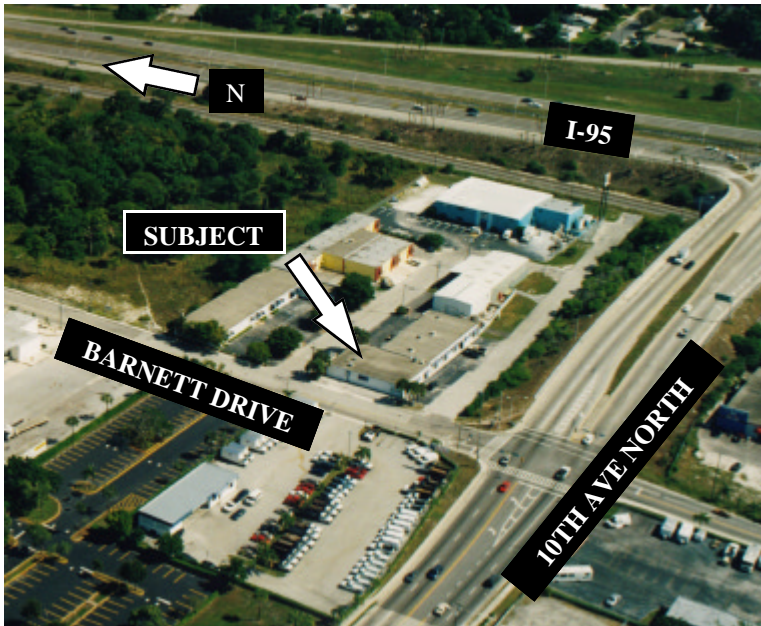

- 2350 Sq. Ft. Available
- Divisible
- Immediately West of the I-95/10th Ave. North interchange, on Barnett Drive.

I-95 and 10th Avenue North

Lake Worth, Florida

Great Central Palm Beach County Location!!!

- 100% Air Conditioned with showroom, and (1) 10' X 10' overhead grade-level loading door.
- Light industrial Zoning allows warehouse / office / showroom.
- CBS/Twin "T" Roof. Sprinklered Building.
- Utilities: city water, sewer, electric.

